



6/1-12 Carrol Crescent Plumpton NSW

4 2 2

The collection of New Houses at Plumpton reflects the diverse needs and lifestyle choices of modern families. 4 oversized bedrooms sharing a spacious living area are in a prime location in Plumpton.

The master bedroom has an en-suite and plenty of wardrobe space. The other bedrooms have built in robes and share a large bathroom with separate shower and bath. There is heaps of storage and a convenient laundry plus a well fitted out kitchen accessed by the dining area.

- ? Spacious bedrooms
- ? Master bedroom with built-in robe and en-suite
- ? Modern kitchen with gas cooking
- ? Dishwasher and oven included
- ? Internal Laundry
- ? Security Alarm
- ? Intercom
- ? Air Conditioning

View : <https://www.spgr.com.au/6107647>



Successful Properties
9688 2097



Rooty Hill Road North 266 PLUMPTON

4 2 1 1

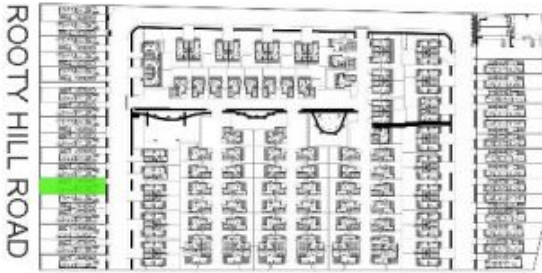

ROOTY HILL ROAD



LOT 6



CARROL CRESCENT

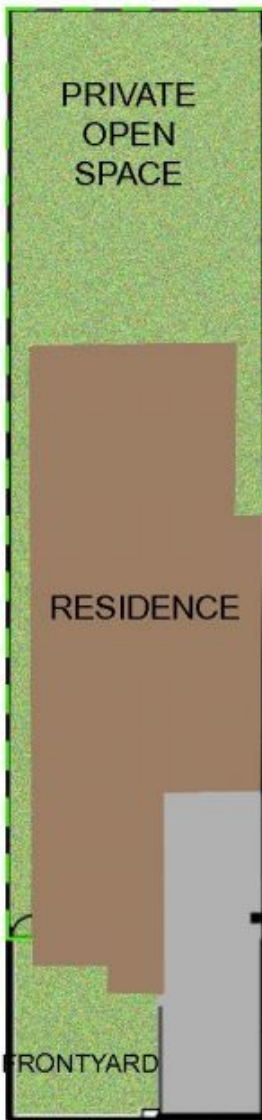

LOT SIZE	316.82 SQ.M
Living Area :	133.74 SQ.M
Garage :	17.0 SQ.M
Covered carport :	13.0 SQ.M
Porch+Patio:	13.0 SQ.M
Backyard:	114.6 SQ.M
Frontyard:	23.48 SQ.M

Area quoted to be used as guide only. This plan is for illustration purposes only. All information contained is gathered from sources deemed to be reliable. We have no doubt it is accurate however we cannot guarantee it. Areas are subject to final survey. Layout may change due to final council approval. The marketing plan and strata plan area will vary because of the different methods of calculation adopted. The marketing plan area is based on gross floor areas.