

3/302 Flushcombe Road Prospect NSW

3 2 2

This brand new quality built 3 bedroom duplex townhouse is nearing completion, ready to move in.

In a great location, next door to manicured Reserve and across the road from the bus stop, this home comes with full turn-key fit out, ready to move in.

Featuring:

- ? 3 generous size bedrooms all with built in robes
- ? En-suite to Master Bedroom
- ? Contemporary design kitchen with stone bench tops and gas cooktop
- ? Stainless Steel appliances including dishwasher
- ? Stylish bathrooms
- ? Internal Laundry
- ? Security Alarm
- ? Intercom

Price : Under Contract

View : <https://www.spgr.com.au/6107908>



Successful Properties
9688 2097



Qiuling (Jolin) Wang
9688 2097

302 FLUSHCOMBE RD

BLACKTOWN

U-3

- 3 BEDROOM
2 BATHROOM
2 GARAGE



SITE PLAN

KEY FEATURES

1. ULTRA MODERN KITCHEN & BATH
2. ENERGY - EFFICIENT APPLIANCES
3. INNOVATIVE DESIGN
4. STEPS MAY BE INTRODUCED IN THE HOUSE DEPENDING ON THE TOPOGRAPHY OF THE SITE



GROUND FLOOR

FIRST FLOOR



ARTIST IMPRESSION

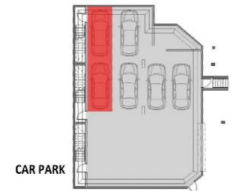

CAR PARK



PROPERTY PLAN

				GROUND FLOOR (INC. GARAGE, PATIO & PORCH)	TOTAL AREA (G.F. + 1st FLOOR + CARPARK)
3	2	2	-	69 m ²	207 m ²
				FIRST FLOOR	
				70 m ²	
				CAR SPACE	
				m ²	
				OPEN SPACE	
				68 m ²	

Arranged to be used as guide only. This plan is for illustration purposes only. All information contained is gathered from sources deemed to be reliable. We have no doubt it is accurate however we cannot guarantee it. Areas are subject to final survey. Layout may change due to final council approval. The marketing plan and strata plan area will vary because of the different methods of calculation adopted. The marketing plan area is based on floor areas while the strata plan area is based on Strata Schemes (Freehold Development) Act 1973. Note: Store(s), Robe(s), Linen(s), Bath fixtures, Laundry fixtures & Kitchen joinery fixtures, form part of sales package. TV and other items such as credenza, sofa, study desk, TV units & beds are not included as part of sale. Windows and doors sizes are indicative and subject to change based on legislative approval.