





**15 Emblica Glade Kellyville Ridge NSW**

5  3  2 

Enjoying this fantastic 5 bedrooms townhouse in the heart of Kellyville Ridge.

Offering the sunny north facing entry and convenient lifestyle. Superbly positioned within walking distance of Stanhope Village, Leisure Centre Stanhope, John Palmer Public School, public bus, local parks and easy access to Kellyville Metro Station, Rouse Hill Town Centre. Perfect for a growing family, an investor or first home buyers.

**Features:**

- Spacious open style living and dining area easily connecting to the large alfresco.
- 5 oversized bedrooms all with built - ins and master with walk - in robe and ensuite.
- 4 bedrooms, 2 bathrooms upstairs with extra family area and storage.
- 1 bedroom, 1 bathroom ground floor with separate laundry room.

**Price** : \$ 835,000

**View** : <https://www.spgr.com.au/6325497>

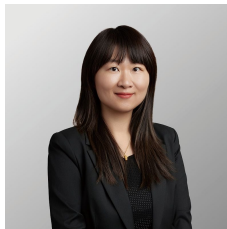

**Wenzhuo (alice) Wang**  
**0432182273**

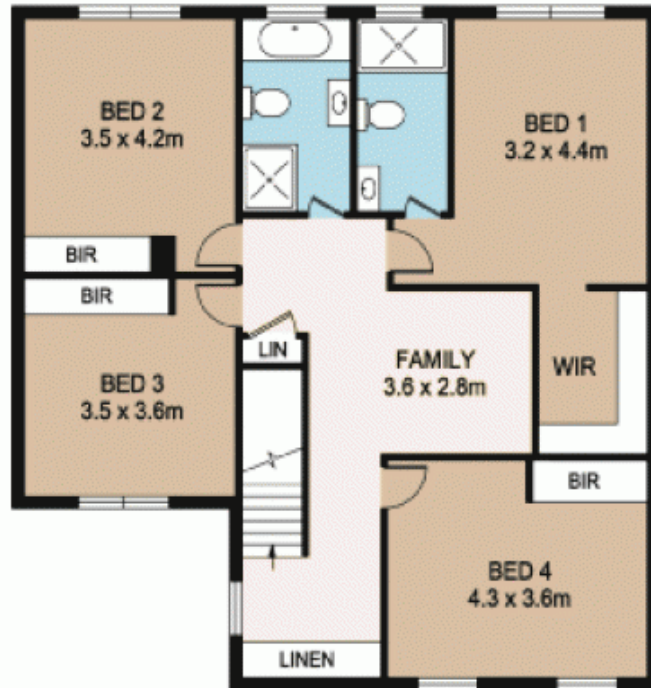

FIRST FLOOR

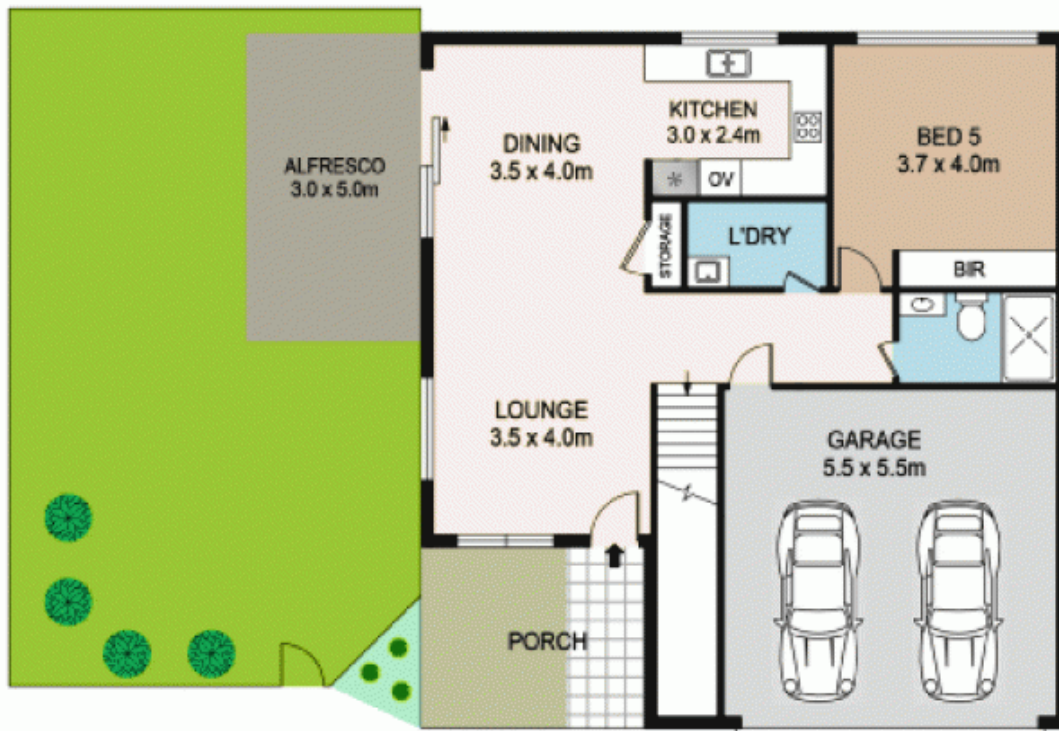

GROUND FLOOR

## 15 EMBLICA GLADE, KELLYVILLE RIDGE



### DISCLAIMER

PLANS SHOWN ARE FOR MARKETING PURPOSES ONLY. ALL DIMENSIONS ARE APPROXIMATE AND NOT TO SCALE. THEY ARE SUBJECT TO ERRORS AND INACCURACIES AND NO LIABILITY WILL BE ACCEPTED. INTERESTED PARTIES SHOULD MAKE THEIR OWN INQUIRES.