



60 Rosebrook Avenue Kellyville Ridge NSW

5 3 2

Perfectly positioned in a quiet and friendly neighborhood, the new owner of this double storey house will enjoy all of the benefits of this Kellyville Ridge neighborhood. With walking distance to John Palmer Public School, Stanhope Village, sporting fields, parks and restaurants. This bright and well-maintained house is an excellent opportunity for growing families, downsizers and/or investors.

Price : \$ 1,325,000

View : <https://www.spgr.com.au/6698231>

Property Features Include:

- Sunny Open plan family, dining and kitchen area
- Modern design kitchen with stone benchtop and quality stain steel appliances
- Five spacious bedrooms all with built-in
- One bedroom and bathroom downstairs
- Spacious master bedroom with ensuite and large balcony
- Quality laminated floorings in bedrooms and tile flooring throughout living and dining areas
- Ducted Air-conditioning, gas cooking and hot water

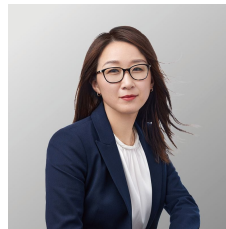

Jinping (emma) Zhang
9688 2097

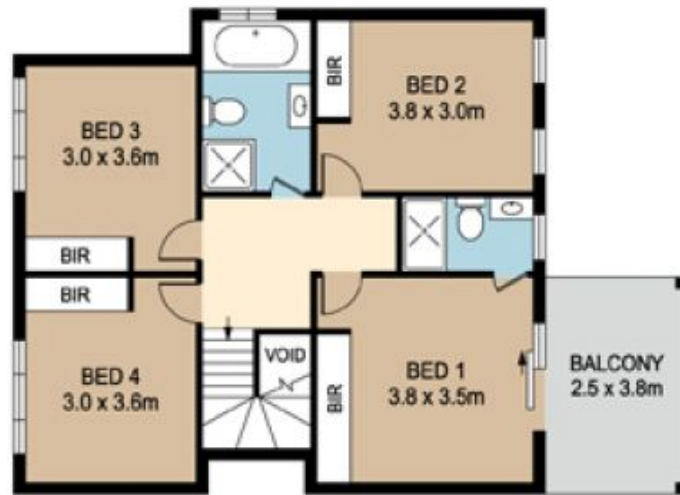

FIRST FLOOR



GROUND FLOOR



SITE PLAN

60 ROSEBROOK AVENUE, KELLYVILLE RIDGE



DISCLAIMER PLANS SHOWN ARE FOR MARKETING PURPOSES ONLY. ALL DIMENSIONS ARE APPROXIMATE AND NOT TO SCALE. THEY ARE SUBJECT TO ERRORS AND INACCURACIES AND NO LIABILITY WILL BE ACCEPTED. INTERESTED PARTIES SHOULD MAKE THEIR OWN INQUIRES.