



## 2 Pipeclay Road North Kellyville NSW

5 3 2

Successful Properties Group is proud to present this Brand NEW 5 bedroom family home in the tranquil suburb of North Kellyville. Centrally located with a peak view, this spacious and sun-drenched residence is truly breathtaking.

**Land Size** : 457.7 sqm

**View** : <https://www.spgr.com.au/7042740>

A corner block with a land size of 465 sqm and internal area of 310sqm. The home offers multiple living areas, a ground floor bedroom with an en-suite, an impressive and spacious deck, making it the perfect place for relaxing with family and entertaining friends.

Within a short drive to local shops, quality local schools and newly renovated parks, this incredibly convenient home that will tick all your boxes!

Features:

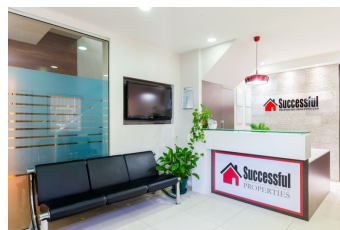

**Successful Properties**  
**9688 2097**



FIRST FLOOR



GROUND FLOOR

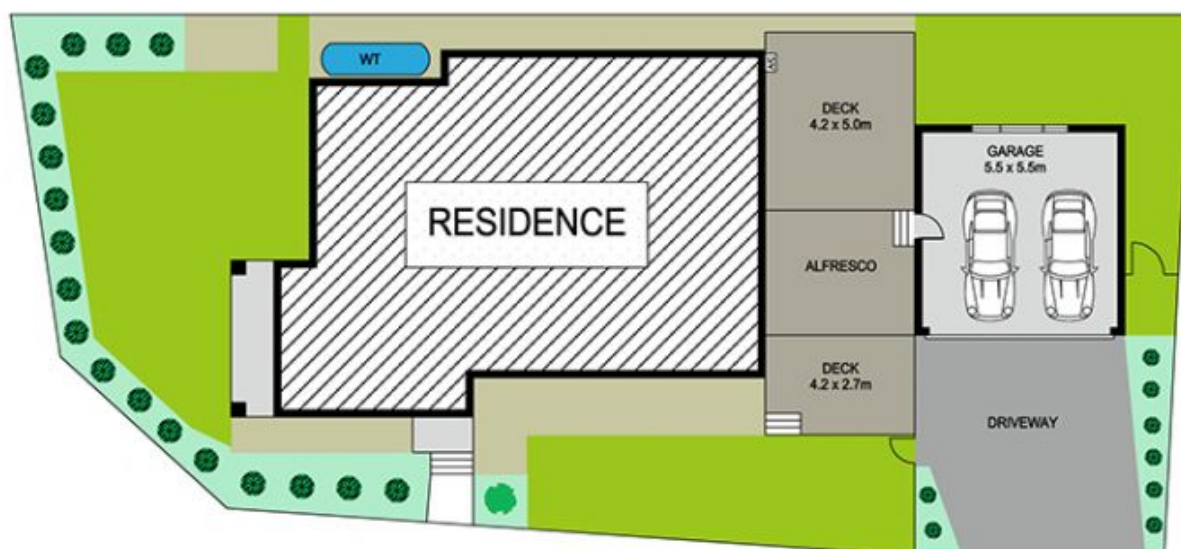

SITE PLAN

## 2 PIPECLAY ROAD, NORTH KELLYVILLE



DISCLAIMER PLANS SHOWN ARE FOR MARKETING PURPOSES ONLY, ALL DIMENSIONS ARE APPROXIMATE AND NOT TO SCALE. THEY ARE SUBJECT TO ERRORS AND INACCURACIES AND NO LIABILITY WILL BE ACCEPTED. INTERESTED PARTIES SHOULD MAKE THEIR OWN INQUIRES.