



502/2D Wharf Road East Melrose Park NSW

1  1 

SPGR is proudly present this modern and cosy studio in "Melrose Park Village", the first smart living community in Sydney. It's a very well-built complex with free shuttle service on site to Meadow bank train station or ferry wharf. It offers contemporary design and quality finishes. The enclosed winter garden can be easily converted to home office, study or gym. And the studio is naturally divided into living space and bed area. Perfect for young people having their first home.

Feature:

- Modern kitchen with gas cooking, built in microwave, stone bench and marble look splash back
- NBN connection
- Storage cage
- Nice green outdoor space in the complex
- Sensor street lighting

Price : \$ 420,000

View : <https://www.spgr.com.au/7946921>



Qiuling (jolin) Wang
9688 2097



Successful Properties
9688 2097

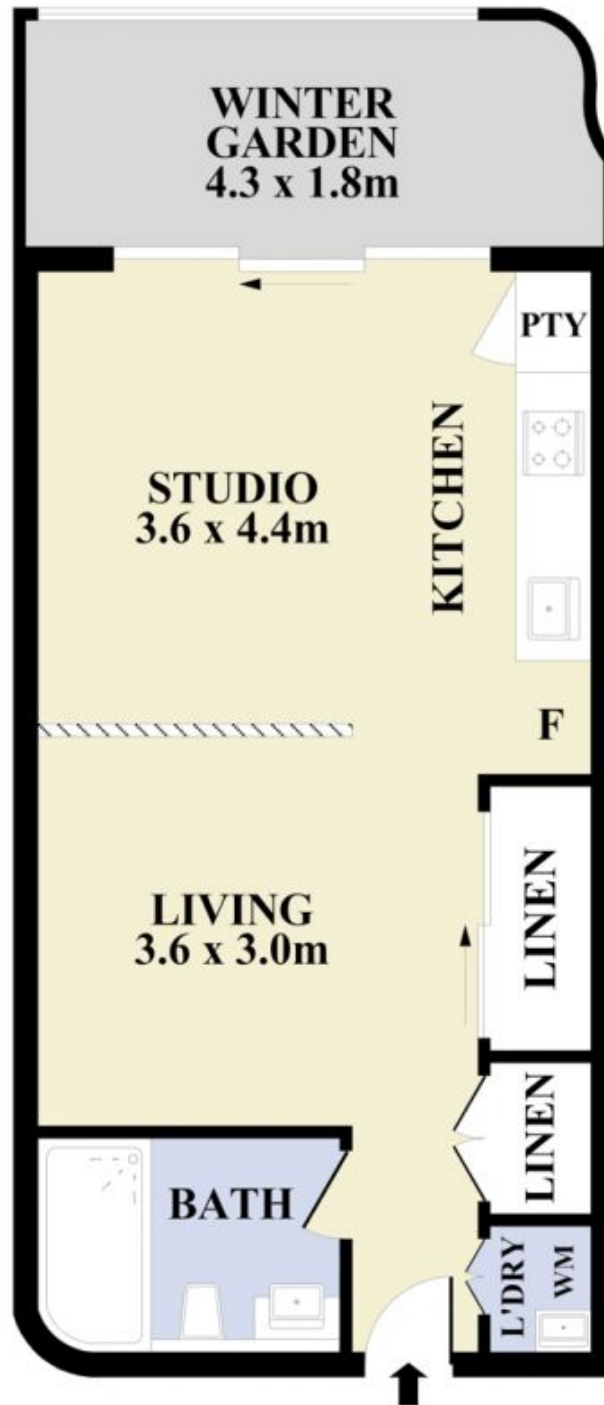

Plans shown are for presentation purposes only and not part of any legal document or title. They are subject to errors, omissions, inaccuracies and should not be used as a sole and accurate reference interested parties should make their own inquiries using independent sources.



502/2 Wharf Road, Melrose Park